

DETALHE PLACA 01 S/ESC

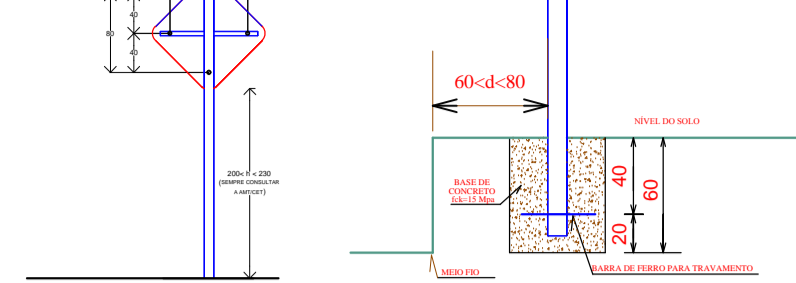

DETALHE PLACA 02 S/ESC

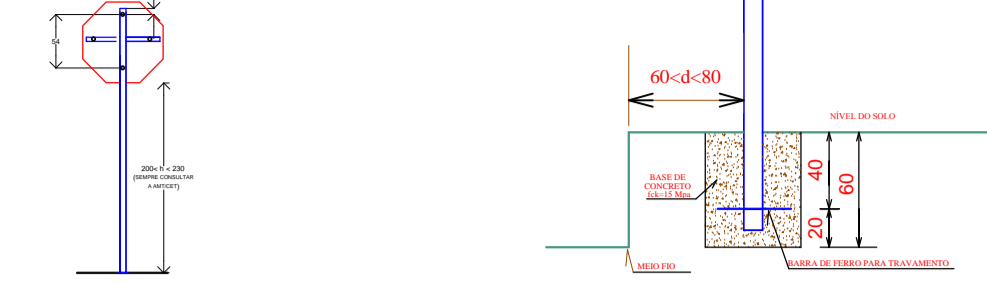

DETALHE PLACA 03 S/ESC

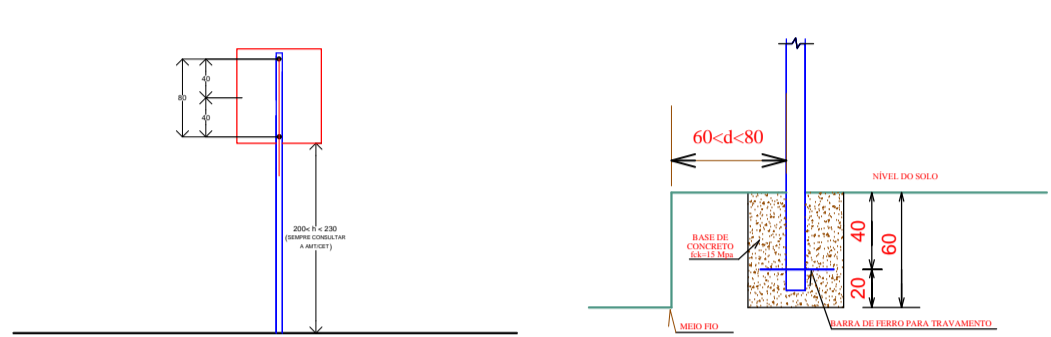

DETALHE PLACA 04 S/ESC

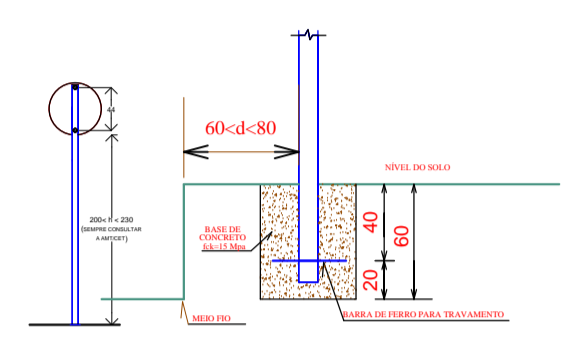

DETALHE PLACA 05 S/ESC

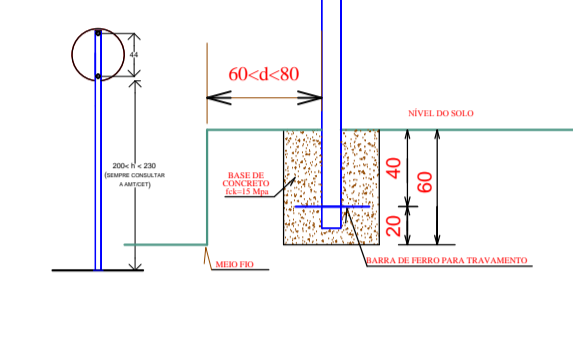
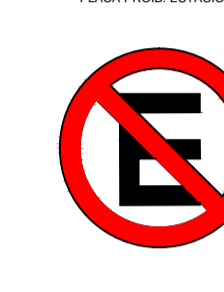

DETALHE PLACA 06 S/ESC

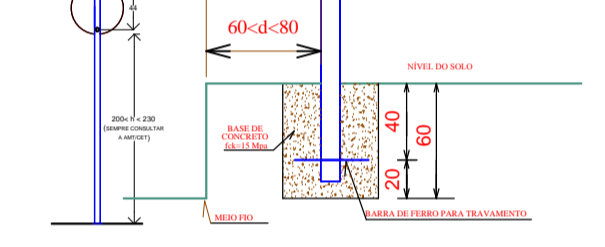

DETALHE PLACA 07 S/ESC

VER MEMORIAL DESCRITIVO

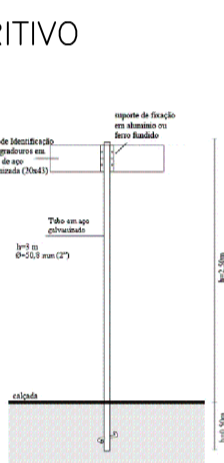

DETALHE PLACA 08 S/ESC

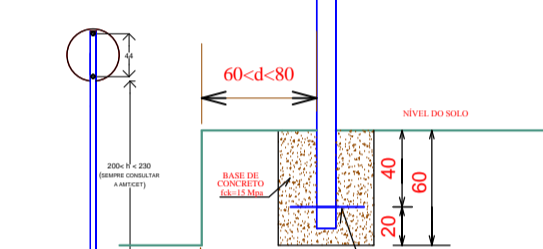

DETALHE PLACA 09 S/ESC

DETALHE CESTINO DE LIXO - S/ESC

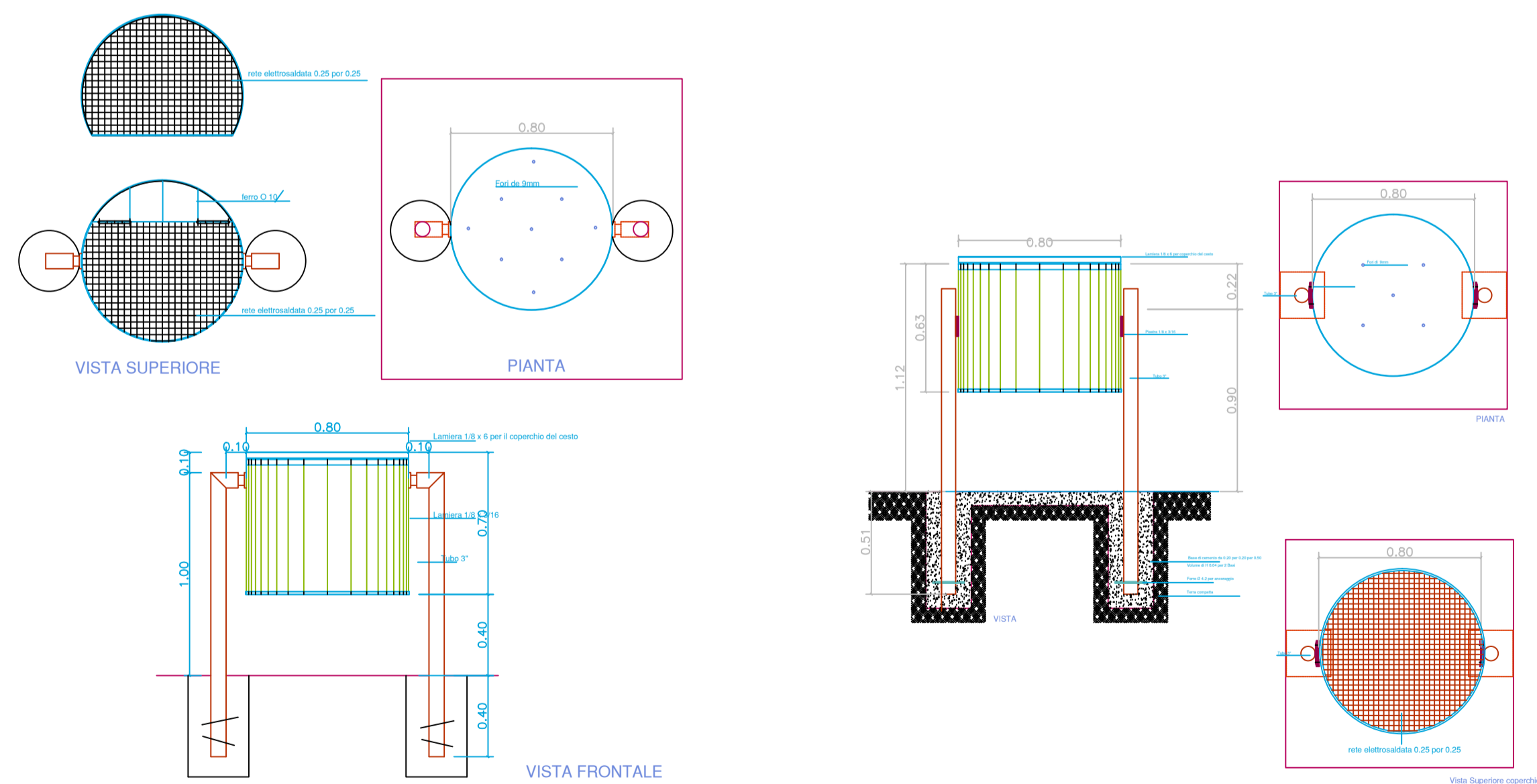

DETALHE BANCO MADEIRA - S/ESC

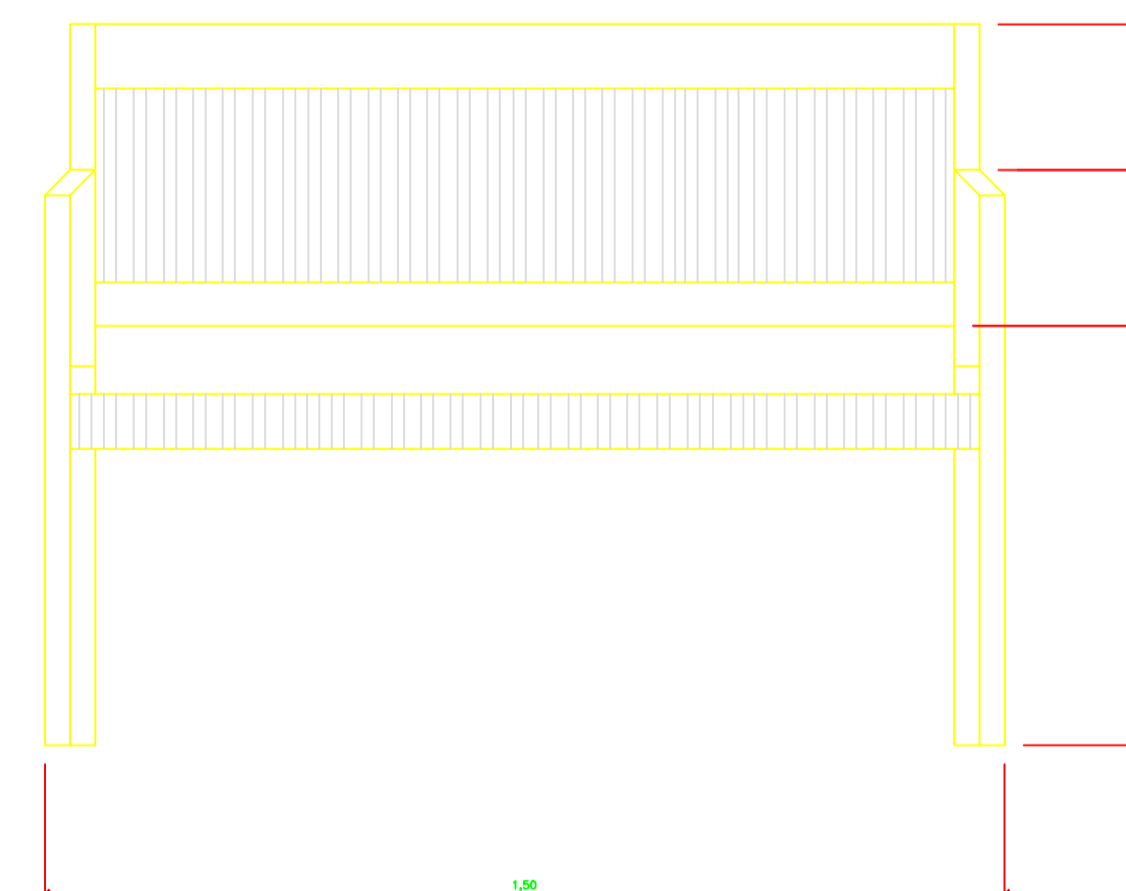

DETALHES SINALIZAÇÃO HORIZONTAL - ESC 1/20

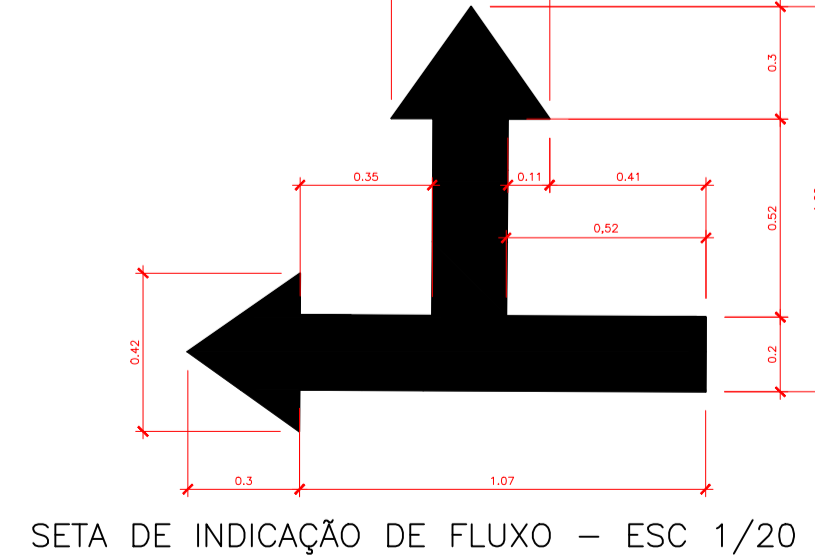

SETA DE INDICAÇÃO DE FLUXO - ESC 1/20

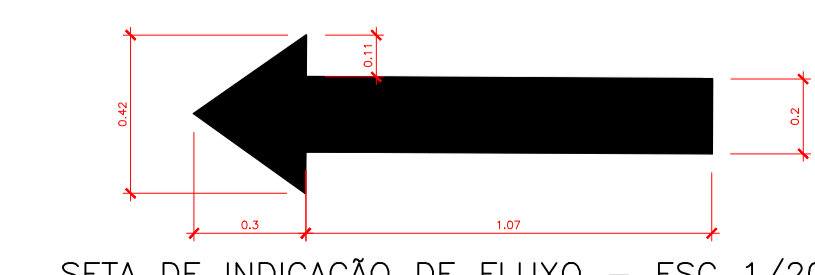

SETA DE INDICAÇÃO DE FLUXO - ESC 1/20

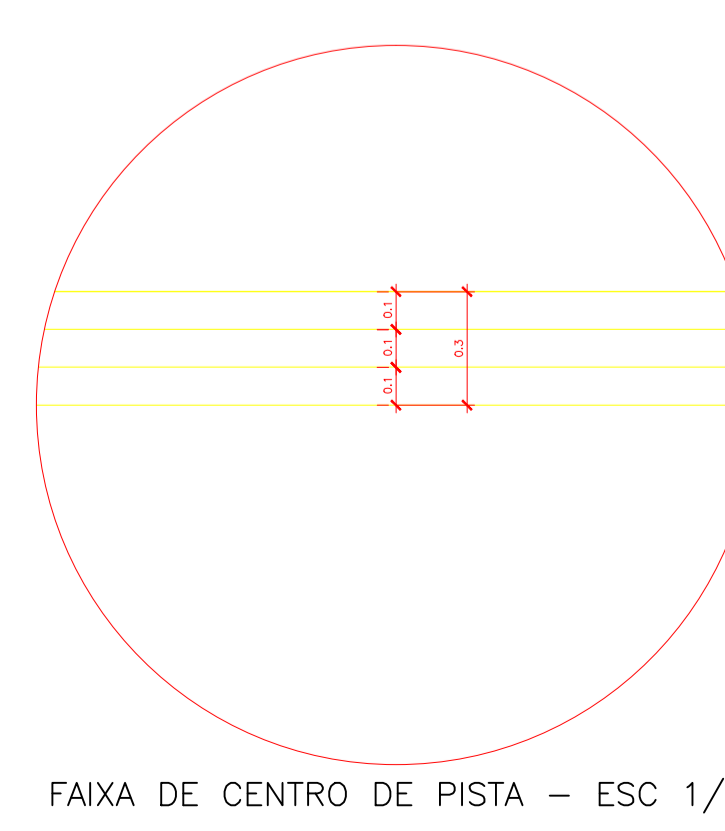

FAIXA DE CENTRO DE PISTA - ESC 1/20

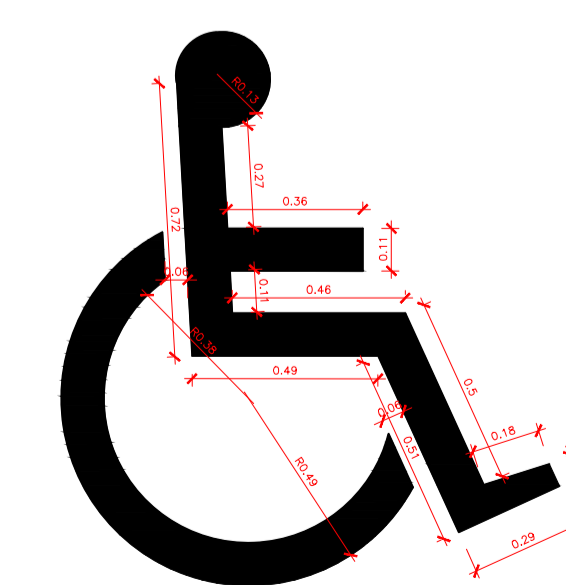

DEM. DE ESTACIONAMENTO IDOSO ESC 1/20

PREF. MUN. DE SÃO CRISTOVÃO DO SUL	
	TÍTULO PLANTA DE SINALZ. VIÁRIA E DETALHES
REFERÊNCIA PAV DA RUA RITA DE CASSIA E EGÍDIO DEITOS	FRANCHA 03/03
PROPRIETÁRIO PREFEITURA SCS	ASSINATURA
RESPONSÁVEL TÉCNICO ENG. CIRO FONTANA SURDI	PREFEITURA
DESENHO 01	ESCALA INDICADA
	DATA REV 01 29/05/2014